

# Your worldwide link to ultimate Conveyor Solutions



YOUR WORLDWIDE LINK TO ULTIMATE CONVEYOR SOLUTIONS



## Overhead Conveyor

### Manual System F50 and F80

Manually operated conveyors are used for transport of products suspended in a trolley, which is mounted in a C-track.

For larger products the trolleys are built together with a traverse, from which the products are suspended.

**Max. load each trolley:**

F50: 200 kg

F80: 500 kg

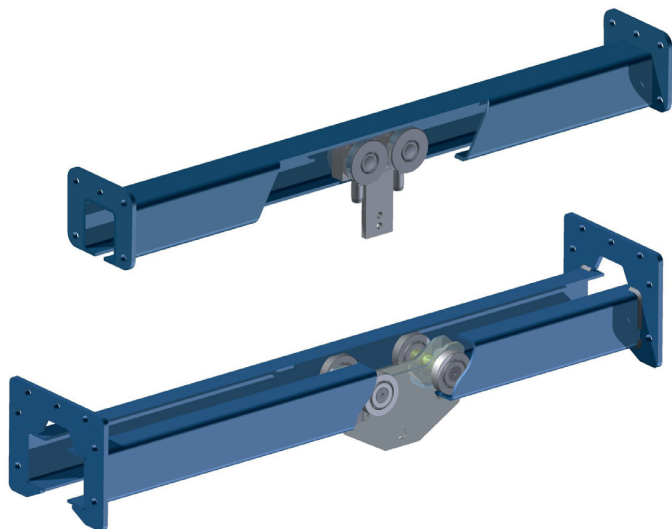

### Single Conveyor SC

Single conveyors are driven and typical used for transport of items going through the same process, e.g. painting lines.

The products are suspended in a cardanchain continuously running in a C-track. The cardanchain is capable of running in horizontal and vertical bends.

The profile can be used with the slot upwards or downwards. The chain comes with different pitches and hangers.

**Max load:**

Hanging from 4 points traverse – 360 kg.

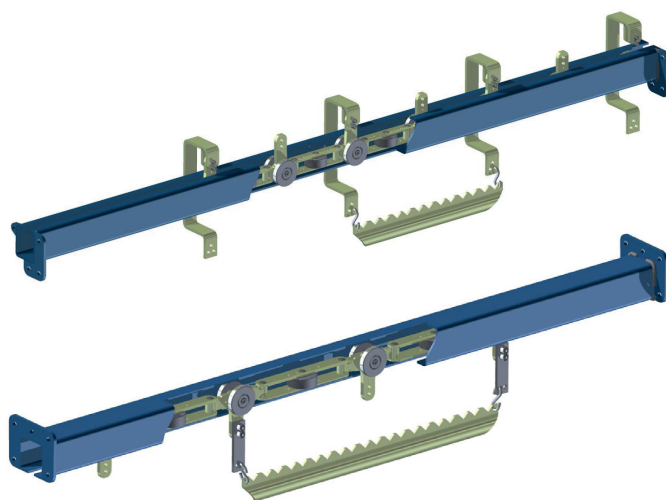

### Power & free conveyor PF30, PF68, PF80

Power and free systems combine the single conveyor with free trolleys carrying the loads.

Typical applications are paint lines where products need to be routed to multiple spray booths and where accumulation in ovens and buffer zones are required.

Also very suitable for assembly lines.

**Max. load each trolley:**

PF30: 200 kg

PF68: 200 kg

PF80: 500 kg

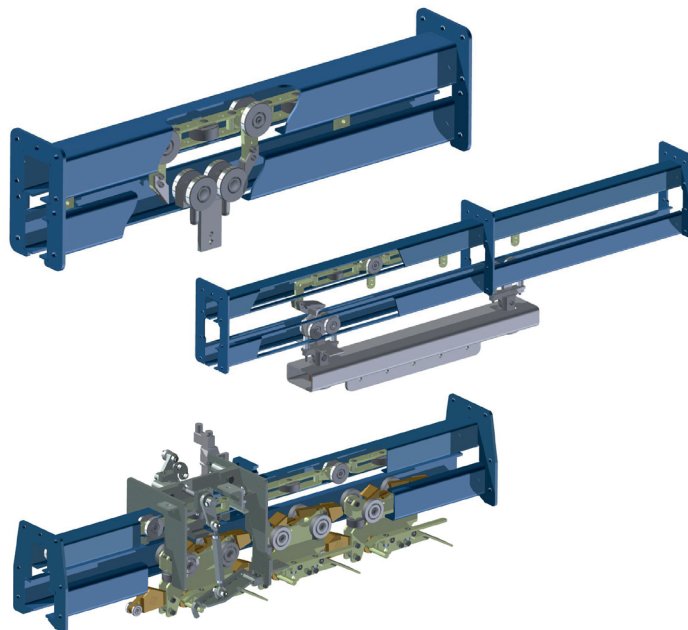

## PFT conveyor

Due to the double track system this conveyor type is very stabile. This design allows for a 3 m long suspension bar with a turning device on each trolley. In the process line the suspension bar will turn parallel to the moving direction and in buffer zones it will simply turn 90° for maximum accumulation capacity.

**Max. load each trolley:**

85 kg.

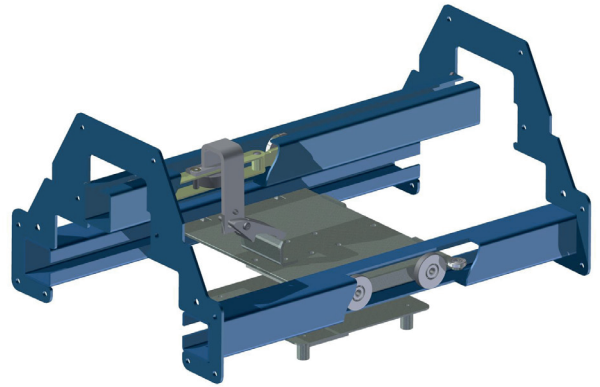

## Floor Conveyor

Floor conveyors eliminate the call for at a steel structure since it is fixed to the existing floor. Widely used for assembly lines as well as painting lines in combination with robots.

Applicable in power and free versions with accumulation but also in a more cost effective fixed engagement version.

**Max. load each trolley:**

FSC:	15 kg
FTL:	30 kg
FTM:	200 kg
FTH:	500 kg

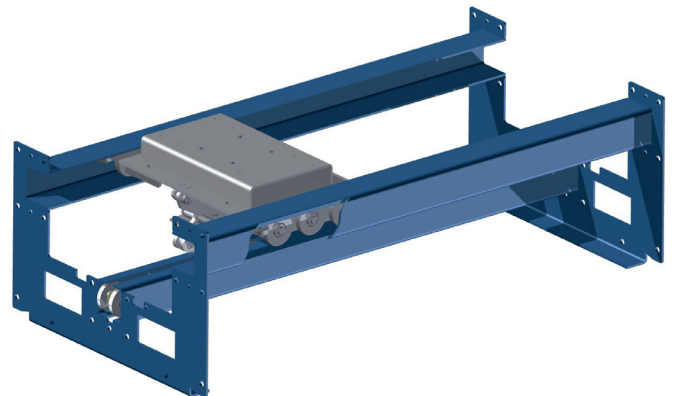
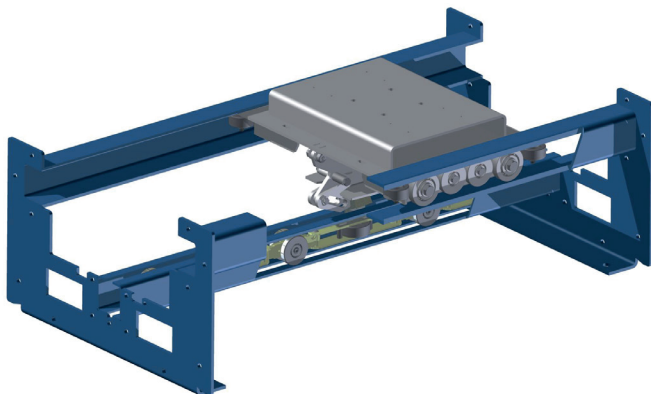
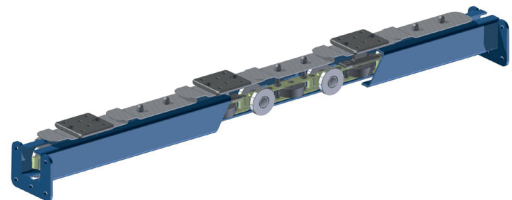

Our products do have a wide range of accessories available such as switch tracks, lifting devices, accumulation stops, transfer units and turning devices. Thanks to the modularity our systems can be combined in countless ways.

We combine our standard components with custom designed solutions as needed. In fact our most valuable product is our capability to provide our customers with very competent engineering based on many years of experience.

## Profile – Conveyor Technique A/S

A well proven and reliable product combined with Know-how, engineering and project management forms the base of Conveyor Technique. Our engineers take pride in our high quality products to meet our customer's demands best possible. What ever we do - we do it right. Compromising on quality or safety is simply not an issue at Conveyor Technique.

Our sales staff and engineers offer you all the help you need during the design phase. Why not take advantage of our many years of experience when it comes to conveyor systems. Define your needs and we will design your conveyor systems in the most professional and cost efficient way. We have agents in all European countries and many countries outside Europe to assist you. All inquiries get our full attention – from the small manual line to the fully automated and PLC controlled system.

Most often we use our wide range of standard components to do the trick but we are in no way limited in that direction. One of many advantages in choosing Conveyor Technique is our capability to design special solutions when required.

Our contract managers are used to cooperate with other constructors during projects. We participate in project meetings and make things run smoothly based on experience and good practice. Our supervisors will coordinate the installation and take care of the commissioning.

Would you ever buy a car without a service agreement or spare parts available? No, most likely not. Neither would Conveyor Technique deliver a conveyor system without a complete Installation, Operation and Maintenance manual. After sales you will still have our full attention. Most spare parts are in stock and our skilled service technicians are ready to assist you when ever needed. We always offer our customers a complete service package.

That's why you will find more than 1.000 Conveyor Technique installations running every day worldwide in paint shops, assembly lines, warehouses etc. and often in very harsh environments with temperatures up to 250°C.

FOR MORE  
INFORMATION!

