

Overhead Conveyor Power & Free Type PF 68

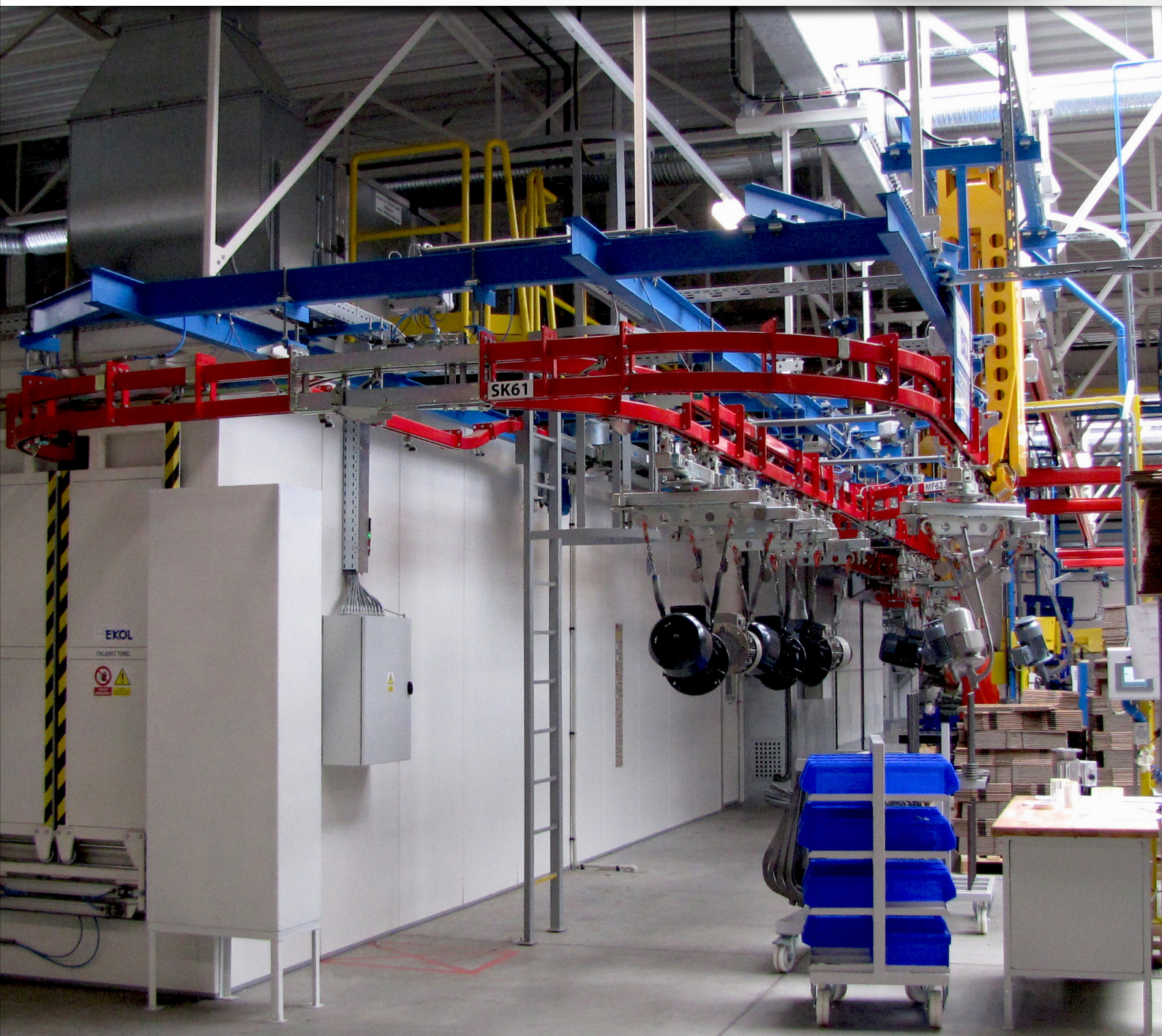

©2014 Conveyor Teknik A/S

YOUR WORLDWIDE LINK TO ULTIMATE CONVEYOR SOLUTIONS



Durable, powerful and able to withstand even the most demanding conditions with up to an 800 kg payload.

Power track

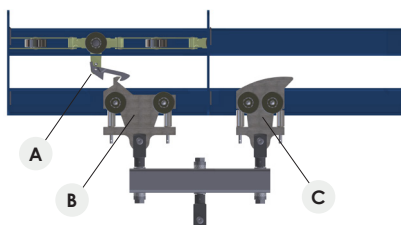
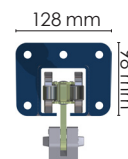

Power & Free track

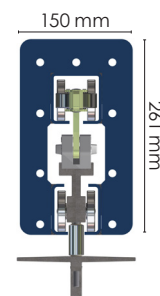

- (A) Pivoting pulling dogs mounted on cardchain at fixed pitch
- (B) Front trolley
- (C) Rear trolley

The Power & Free conveyor type PF68 consists of two tracks. In the upper "Power" track a cardchain with pivoting pulling dogs (A) attached at a fixed pitch. In the underlying "Free" tracks the trolleys are moved throughout the system.

The trolleys and chain are linked by the pivoting pulling dogs. Engagement is achieved by allowing the pulling dogs (A) to remain in the lower position and connect with the front trolley. (B) E.g. When an accumulation stop is opened.

Front trolleys (B) are disengaged upon reaching closed accumulation stops or buffering behind rear trolleys. (C) The pulling dogs (A) pivot upwards and are freed from the trolley. The PF68 accumulation system has a minimum of moving parts and is therefore simple to maintain.

The PF 68 trolleys' accumulation configuration and accumulation stops ensure that trolleys/carriers are immediately released from the power chain enabling them to accumulate in 30°, 45°, 60°, 90°, 120° or linear buffer zones.

The cost effective modular PF68 system is assembled specifically to meet customer requirements. Chain pitch, trolley capacity and carrier size as well as accumulation distance are just a few of many parameters designed to meet customer demands.

PF68 is powered by one or more electrically operated drive units. The system can be designed with multiple chain loops and switch tracks for directing trolleys to numerous required destinations, providing optimal flexibility. An encoding system enables the individual trolleys to activate the switch tracks and the control system ensures that the carriers run through the chosen process areas to the correct stop /buffer positions. If these features are important to you in a transport system, then the PF68 is the perfect solution for your material handling needs.

Trolley types

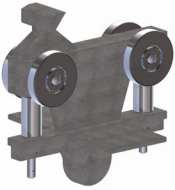

Front trolley



Basic trolley

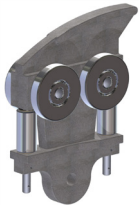

Rear trolley

1 Trolley

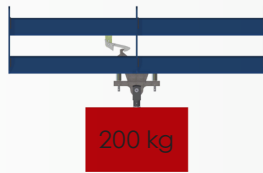

4 Trolleys

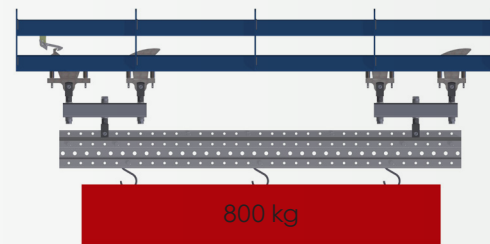

2 Trolleys

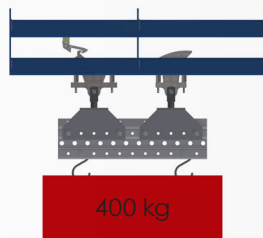

Chain Trolley

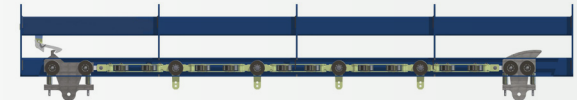

30°-45°-60° Buffer Zone

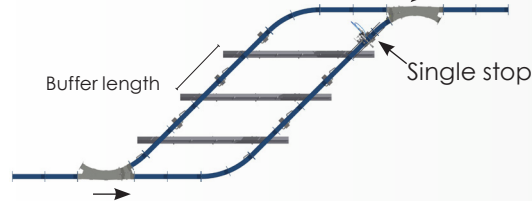

90° Buffer Zone

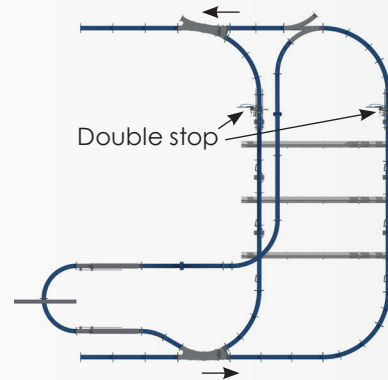

120° Buffer Zone

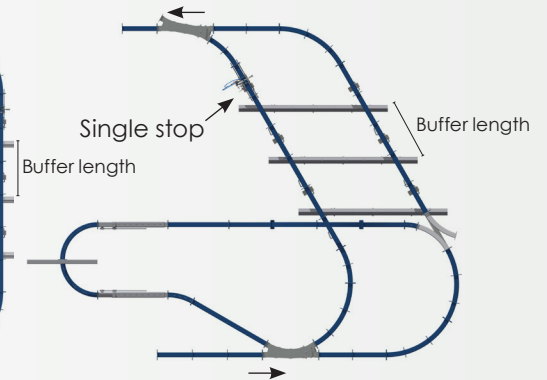

Linear Buffer Zone

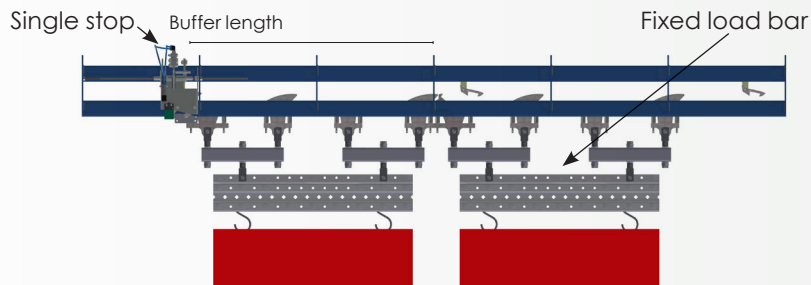

Load bar

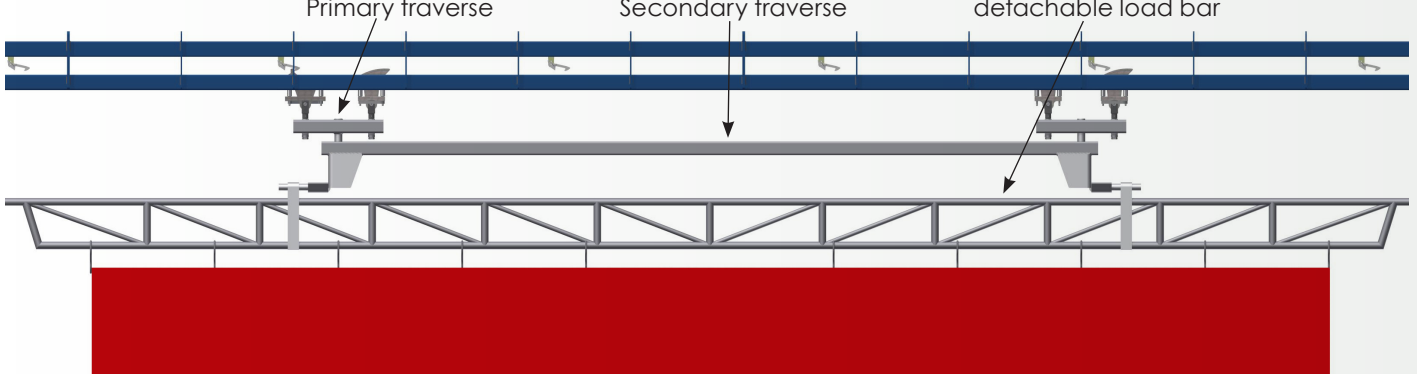

Technical data:

Max. load, each trolley arrangement:

1 trolley (4-wheeled)-200 kg., 2 trolleys-400 kg.,
4 trolleys-800 kg.

Method of Running:

Power & Free or Fixed Engagement.

Accumulation possibilities:

Linear, 30°, 45°, 60°, 90°, 120°.

Min. buffer length:

260, 320 mm.

**Min. distance between front-trolley arrangement and
back-trolley arrangement, for trolleys running in cross section via switch tracks.**

1.000 mm.

Cardanchain, pitch:

180, 270 or 300 mm.

Trolley bearings, Chain bearings:

Open or shielded bearing fitted with grease.

Lubrication:

Automatic lubricator - high temperature oil CT250.

Max. Ambient Temperature:

250° C.

Standard lengths- straight profiles:

1.000, 1.500, 2.000, 2.500, 3.000 mm., fix length under 1.000 mm.

Standard horizontal curves radius- PF track:

R-500, R-700, R-1.000, R-1.500, R-2.000 mm.

Standard horizontal curves angle- PF track:

15°, 30°, 45°, 60°, 90°.

Standard vertical curves radius- PF track:

R-1.250 mm.

Standard vertical curves angle- PF track:

10°, 15°, 30°, 45°, (depending on work-load).

Switch track radius 1.000-30°:

Trolley, pneumatically, electrically, or mechanically (Flip-Flop) operated.

Lifting and lowering station:

Electrically or hydraulically operated.

Floor mounted or suspended from the steel construction.

Available as guided or unguided version.

Applicable in linear section or cross section.

Accumulating stop:

Pneumatic, electrically operated.

Drive Unit:

Straight version with single or double sided drive.

Electric Gear motor with fixed or variable speed via frequency converter. Adjustable Max Torque Limiter. Optional in build encoder with various resolutions.

Innovative custom designs:

Horizontal turning station for carriers, Load bars, Detachable load bars, Manipulators,
Pick and Place Units, High Precision Carrier fixation.

**FOR MORE
INFORMATION!**



©2014 Conveyor Teknik A/S

Headoffice Denmark:

Conveyor Teknik A/S | Industrivej 9 | DK-4700 Naestved
Phone: +45 5573 3400 | Fax: +45 5573 3500
sales@ctas.dk | www.ctas.dk

Conveyor Teknik India Pvt. Ltd. | Door nr. 15 | DRR Avenue, Audco Nagar
Kattupakkam | Chennai- 600056 | India
Phone: +9144 24763760 | www.ctas.dk | sales@ctas.dk